

# iCare

## HIV1&2 Rapid Screen Tester

### Step-by-Step Instructions

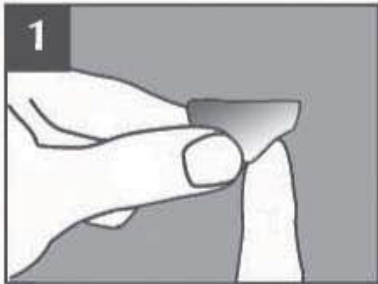

1 Use alcohol prep to clean finger

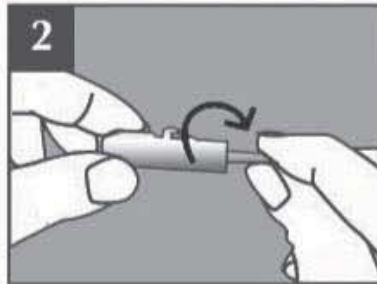

2 To activate lancet, push knob in until "click" sound

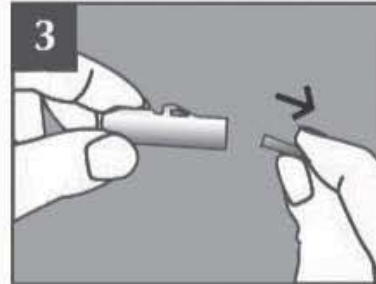

3 Twist and pull out the knob

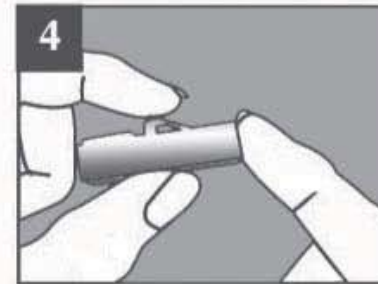

4 Place the activated lancet firmly on the finger and push the trigger to prick the finger

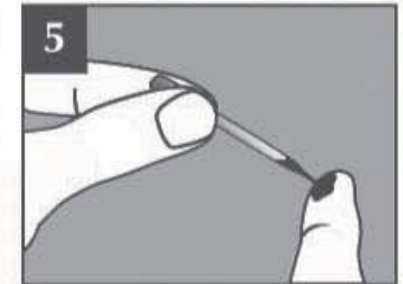

5 Collect blood sample using the micro pipette

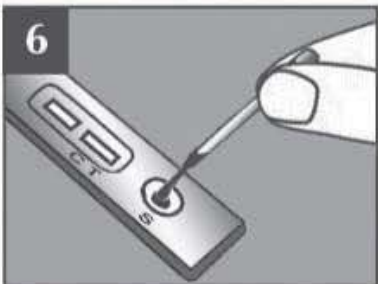

6 Place the blood into the sample well marked "S"

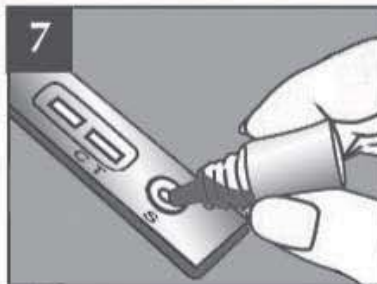

7 Place 2 drops of diluent into the same sample well, marked "S"

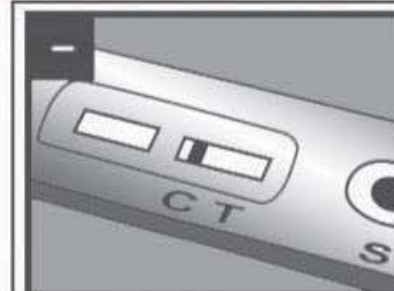

**-**  
**NEGATIVE RESULTS**  
(No HIV anti-bodies detected)  
Pink line next to "C"

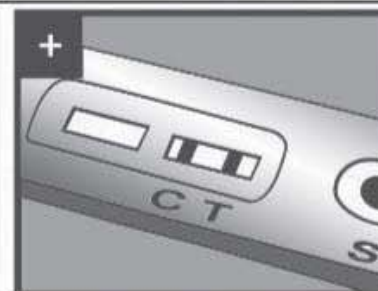

**+**  
**POSITIVE RESULTS**  
(HIV anti-bodies detected)  
Pink line next to "C" and "T"

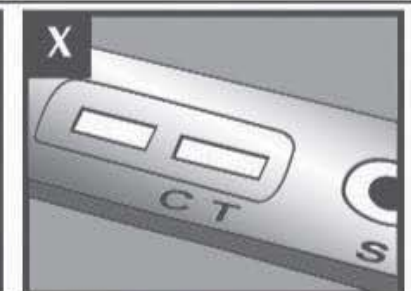

**X**  
**NO RESULTS**  
(Procedure may be faulty, test again using a new kit)

**PLEASE NOTE:**

- When performing the HIV test, the steps must be followed closely
- Use within 10 minutes of opening
- For single test only
- Do not share lancet
- Dispose properly after use.

Store at 2°C to 30°C

FOR IN VITRO DIAGNOSTIC USE

Disclaimer: When performing this HIV test, the steps involved must be followed closely. If there has been a possible exposure to HIV, and the person tested negative for HIV, the test must be repeated in 30 days. It is imperative that a positive HIV test result be followed by a Western Blot or PCR test performed by a doctor or clinic to confirm if you are indeed HIV positive. Since NO test, nor test kit is infallible, it is best to confirm test results by using a licensed medical testing facility. For one time usage only.